

LINE	SYM.#1 PART NO.	SYM.#3 PART NO.	*A*	*B*	*C*	REMARKS	WT. (LBS.)	*D*
01	1Q0716-06	26757-41	20	15 ³ / ₁₆	13 ¹¹ / ₁₆	NON-JACKETED CAR 114" O.D., 1/8" F.F.	23.85	19
02	1Q0716-07	26757-44	17 ³ / ₄	13	11 ³ / ₁₆	JACKETED (4") 102.308" O.D. S.S.	23.24	19
03	1Q3668-20	1Q4857-22	19 ¹ / ₈	14 ⁵ / ₈	13 ¹ / ₈	JACKETED (4") 106" O.D. S.S.	24.3	19
04	1Q0716-15	26757-57	20 ¹ / ₄	14 ¹ / ₁₆	13 ⁷ / ₁₆	NON-JACKETED CAR 102 ⁷ / ₈ " O.D. 1" IN 120" F.F.	25.03	19
05	1Q0716-17	26757-59	14 ³ / ₄	10 ³ / ₈	9 ¹ / ₁₆	JACKETED (4") 111 ¹ / ₈ " O.D. 1/4" F.F.	20.43	19
06	1Q0716-18	26757-60	12 ³ / ₁₆	8 ³ / ₈	7 ¹ / ₂	JACKETED (6") 111 ¹ / ₈ " O.D. 1/4" F.F.	18.5	19
07	1Q0716-22	26757-41	20	15 ³ / ₁₆	13 ¹¹ / ₁₆	NON-JACKETED CAR 114" O.D. 1/8" F.F.	24.1	20 ¹ / ₂
08	1Q0716-25	26757-64	23 ¹ / ₄	18	16 ¹ / ₂	NON-JACKETED 106" O.D. S.S.	27.85	19
09	1Q0716-26	26757-65	20 ¹ / ₈	16 ³ / ₈	15	NON-JACKETED CAR 114" O.D. 1" F.F.	26.06	19
10	1Q0716-27	26757-57	19 ¹ / ₄	14 ⁵ / ₁₆	13 ⁵ / ₁₆	NON-JACKETED 118 ¹ / ₈ " O.D. 1/4" F.F.	24.4	19
11	1Q0716-35	26757-73	16 ⁵ / ₈	11 ¹ / ₁₆	10 ¹ / ₈	JACKETED CAR (6") 90 ¹ / ₄ " O.D. 1/16" F.F.	21.56	19
12	1Q3668-02	26757-59	14 ¹ / ₂	10 ¹ / ₈	9 ³ / ₁₆	JACKETED CAR (4") 111 ¹ / ₈ " O.D. 1/4" F.F. 102" CYL.	16.43	19
13	1Q3668-04	26757-74	19 ³ / ₈	14	12 ¹ / ₂	JACKETED CAR (4") 90.558" O.D. S.S.	24.04	19
14	1Q3668-13	1Q4857-15	15 ⁵ / ₁₆	11	9 ⁵ / ₈	JACKETED CAR, 109 ⁵ / ₈ " O.D., 1/4" F.F.	21.19	19
15	1Q3668-14	1Q4857-17	17 ⁵ / ₁₆	13 ⁵ / ₁₆	12 ³ / ₈	NON-JACKETED CAR, 118 ³ / ₄ " O.D., 1/4" F.F., 149" FROM BOLSTER	19.34	19
16	1Q3668-16	1Q4857-19	22 ³ / ₈	18 ¹ / ₈	16 ⁵ / ₈	JACKETED CAR, 120 ³ / ₈ " O.D., S.S., 149" FROM BOLSTER	27.63	19
17	1Q3668-18	1Q4857-21	15	10 ¹ / ₄	8 ⁷ / ₈	JACKETED CAR, 101 ¹ / ₄ " O.D., 1/4" F.F., 149" FROM BOLSTER	20.2	19
18	1Q3668-21	1Q4857-27	22 ¹ / ₄	18 ¹ / ₂	17	SANDWICH CAR, 120" O.D., S.S.	27.1	17
19	1Q3668-23	1Q4857-29	13 ⁵ / ₈	8 ⁵ / ₁₆	7 ¹ / ₁₆	JACKETED CAR, 103 ⁵ / ₈ " O.D., 1/4" F.F., 149" FROM BOLSTER	19.0	19

SYM.	PART NO.	REQ.	DESCRIPTION	MATERIAL	WT.#
1	TABLED	1	CHANNEL SHAPE	G40.21-44W	~
2	25809-28	1	RECTANGULAR SHAPE	G40.21-44W	3.83
3	TABLED	1	RECTANGULAR SHAPE	G40.21-44W	~

NOTES:

- ALL WELDING SHOULD BE IN ACCORDANCE WITH WITH PROCOR STANDARD WELDING PROCEDURE UNLESS OTHERWISE NOTED.
- THIS DWG. IS NOW TO BE 1" GREATER FOR A, B & C DIM'S THAN ACTUAL FOR SHOP TO TRIM @ ASSY.
- LINES MARKED WITH * INDICATE THAT A, B & C DIM'S ARE ACTUAL SIZE WITH NO ALLOWANCES FOR TRIMMING.

* VERIFIED

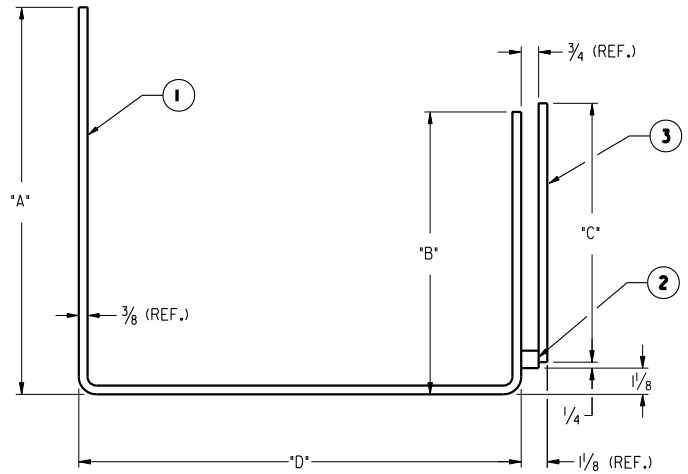
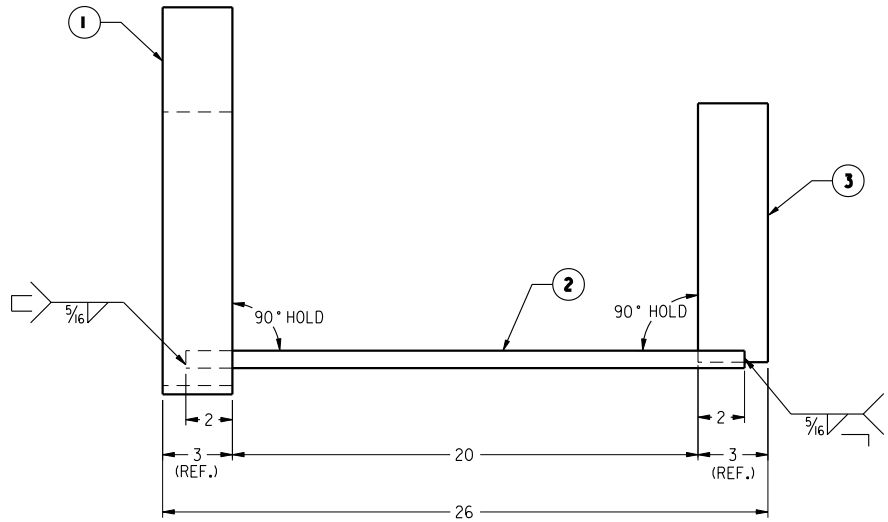

G	06.21.00	K.LIU	LINE 03 REDESIGNED.	PY
F	03.18.99	T.C.	NOTE #3 ADDED.	R.M.
E	10.05.98	K.LIU	REDRAWN ON CAD	R.M.
D	03.06.92	KWL	*D* DIM. ADDED TO TABLE	KWL
C	01.08.91	B.McG	LINE 01 & 02 REDESIGNED.	B.McG
B	01.03.91	B.McG	LINE 02, DIM. "A" WAS 18 ³ / ₁₆ ", DIM. "B" WAS 13", DIM. "C" WAS 11 ⁵ / ₈ "	B.McG
A	12.03.90	B.McG	SYM. #1 WAS PART #100706-06 (LINE 01 ONLY.)	B.McG
REV	DATE	BY	DESCRIPTION	CHK'D

PROCOR
PROCOR LIMITED
 RAIL CAR DIVISION
 200 SPEERS RD.
 DAYVILLE, ONTARIO
 L6A 5E1

**SUPPORT S/A
 BRAKE ROD LEVER**

DRAWN BY: D.P. DATE: 11/21/90
 CHECKED BY: B.McG DATE: 09/16/98
 APPROVED BY: DATE:

SCALE: N.T.S. DRAWING NO. **93498** REVISION **G**

WEIGHT: TABLED

DRAWING TOLERANCES	
FRACTION DIMENSIONS:	± 1/16
ANGULAR DIMENSIONS:	± 1°
ALL DIMENSIONS ARE IN INCHES UNLESS OTHERWISE SPECIFIED	

ORIGINAL WHEN STAMP IS RED

THIS PRINT, INCLUDING ALL INFORMATION SET FORTH THEREON, IS PROVIDED IN CONFIDENCE AND WITH THE UNDERSTANDING THAT NO COPIES OF THIS PRINT OR OF THE INFORMATION SHALL BE MADE WITHOUT THE PRIOR WRITTEN CONSENT OF PROCOR LIMITED. ALL RIGHTS TO DESIGN AND INVENTION ARE RESERVED.