

LINE	PIPE O.D.	"A"	"B"	"C"	"D"	"F"	"L"	REMARKS (TANK O.D.)	WT. (LBS.)	LINE
01	4 1/2	26.15	4 1/2	1 5/16	45.07	12	31 5/8	111 1/8 O.D. TANK, 1/4 F.F.	51	01
	4 3/16	26.15	4 3/16	1	45.12	12	31 1/16	111 1/8 O.D. TANK, 1/4 F.F.	52	
	4 3/8	26.15	4 5/8	1	45.17	12	31 1/8	111 1/8 O.D. TANK, 1/4 F.F.	53	
02	4 1/2	27.35	5 1/16	3/8	52.22	5	33 9/16	118 3/4 O.D. TANK, 1/4 F.F.	55	02
	4 3/16	27.35	5 1/8	3/8	52.27	5	33 3/8	118 3/4 O.D. TANK, 1/4 F.F.	56	
	4 5/8	27.35	6	3/8	52.33	5	33 3/4	118 3/4 O.D. TANK, 1/4 F.F.	57	
03	4 1/2	26.57	4 1/16	1 5/16	44.61	12	32	111 3/8 O.D. TANK, S.S.	57	03
	4 3/16	26.57	4 1/2	1	44.66	12	32 1/16	111 3/8 O.D. TANK, S.S.	58	
	4 5/8	26.57	4 3/16	1	44.71	12	32 1/8	111 3/8 O.D. TANK, S.S.	59	
04	4 1/2	27.92	5 3/4	3/8	51.89	5	34 1/16	119.331 O.D. TANK S.S.	56	04
	4 3/16	27.92	5 1/16	3/8	51.94	5	34 1/8	119.331 O.D. TANK S.S.	57	
	4 5/8	27.92	5 5/16	3/8	52.00	5	34 1/4	119.331 O.D. TANK S.S.	58	
05	4 1/2	25.73	4 1/16	1 5/16	44.69	12	31 1/8	111 1/8 O.D. TANK, 3/8 F.F.	51	05
	4 3/16	25.73	4 1/2	1	44.74	12	31 1/4	111 1/8 O.D. TANK, 3/8 F.F.	52	
	4 5/8	25.73	4 3/16	1	44.80	12	31 3/16	111 1/8 O.D. TANK, 3/8 F.F.	53	
06	4 1/2	26.07	4 1/2	1 5/16	44.80	12	31 1/2	111 3/8 O.D. TANK, 1/4 F.F.	51	06
	4 3/16	26.07	4 3/16	1	44.85	12	31 3/8	111 3/8 O.D. TANK, 1/4 F.F.	52	
	4 5/8	26.07	4 5/8	1	44.89	12	31 1/16	111 3/8 O.D. TANK, 1/4 F.F.	53	
07	4 1/2	28.17	5 1/16	1	48.49	12	34 1/4	106 O.D. TANK S.S.	50	07
	4 3/16	28.17	5 3/16	1	48.54	12	34 3/16	106 O.D. TANK S.S.	51	
	4 5/8	28.17	5 1/4	1	48.6	12	34 1/16	106 O.D. TANK S.S.	52	
08	4 1/2	29.59	5 3/4	1 5/16	51.96	12	36 3/16	101 1/8 O.D. TANK, S.S.	58	08
	4 3/16	29.59	5 7/8	1	52.02	12	36 1/16	101 1/8 O.D. TANK, S.S.	59	
	4 5/8	29.59	5 5/16	1	52.09	12	36 1/2	101 1/8 O.D. TANK, S.S.	60	
09	4 1/2	29.34	5 1/16	1	51.62	12	36	102.304 O.D. TANK, S.S.	58	09
	4 3/16	29.34	5 3/4	1	51.68	12	36 1/16	102.304 O.D. TANK, S.S.	59	
	4 5/8	29.34	5 7/8	1	51.74	12	36 3/16	102.304 O.D. TANK, S.S.	60	
10	4 1/2	29.19	5 7/8	1 5/16	52.57	12	36 1/16	101 1/2 O.D. TANK, 1/4 F.F.	58	10
	4 3/16	29.19	6	1	52.63	12	36 3/16	101 1/2 O.D. TANK, 1/4 F.F.	59	
	4 5/8	29.19	6 1/16	1	52.70	12	36 3/4	101 1/2 O.D. TANK, 1/4 F.F.	60	
11	4 1/2	25.97	4 1/16	1	44.55	12	31 3/8	111 1/16 O.D. TANK, 1/4 F.F.	52	11
	4 3/16	25.97	4 1/2	1	44.6	12	31 1/16	111 1/16 O.D. TANK, 1/4 F.F.	53	
	4 5/8	25.97	4 3/16	1	44.65	12	31 1/2	111 1/16 O.D. TANK, 1/4 F.F.	54	
12	4 1/2	26.17	4 1/2	1 5/16	44.93	12	31 5/8	111 3/8 O.D. TANK, 1/4 F.F. DBL. ROLLER SIDE BRG.	56	12
	4 3/16	26.17	4 3/16	1	44.98	12	31 1/8	111 3/8 O.D. TANK, 1/4 F.F. DBL. ROLLER SIDE BRG.	57	
	4 5/8	26.17	4 5/8	1	45.03	12	31 1/16	111 3/8 O.D. TANK, 1/4 F.F. DBL. ROLLER SIDE BRG.	58	
13	4 1/2	29.26	5 3/4	1 5/16	52.07	12	36	101 1/8 O.D. TANK, 1/16 F.F.	59	13
	4 3/16	29.26	5 7/8	1	52.13	12	36 1/16	101 1/8 O.D. TANK, 1/16 F.F.	60	
	4 5/8	29.26	6	1	52.20	12	36 3/16	101 1/8 O.D. TANK, 1/16 F.F.	61	
14	4 1/2	30.57	6 1/16	1	55.93	12	38 3/16	98 1/8 O.D. TANK, 1/4 F.F.	61	14
	4 3/16	30.57	6 3/4	1	56.00	12	38 3/16	98 1/8 O.D. TANK, 1/4 F.F.	62	
	4 5/8	30.57	6 3/8	1	56.07	12	38 1/16	98 1/8 O.D. TANK, 1/4 F.F.	64	
15	4 1/2	27.23	5 1/16	1 1/16	48.22	9	33	114 O.D. TANK, S.S.	54	15
	4 3/16	27.23	5 1/8	3/4	48.27	9	33 1/16	114 O.D. TANK, S.S.	54	
	4 5/8	27.23	5 3/16	3/4	48.32	9	33 3/16	114 O.D. TANK, S.S.	55	
16	4 1/2	26.93	3 1/16	2 1/16	37.11	25	32 1/16	90 1/4 O.D. TANK, 1/4" F.F.	53	16
	4 3/16	26.93	3 1/16	2 1/8	37.17	25	32 1/2	90 1/4 O.D. TANK, 1/4" F.F.	54	
	4 5/8	26.93	3 1/2	2 3/16	37.22	25	32 3/8	90 1/4 O.D. TANK, 1/4" F.F.	55	
17	4 1/2	29	5 3/4	1	51.94	12	35 1/16	102 3/8 O.D. TANK 1/4" F.F.	57	17
	4 3/16	29	5 13/16	1	52	12	35 1/16	102 3/8 O.D. TANK 1/4" F.F.	58	
	4 5/8	29	5 5/16	1	52.06	12	35 3/8	102 3/8 O.D. TANK 1/4" F.F.	59	

SUPERCEDED BY DDB0066-1

SUPERCEDED BY 102629-07

SUPERCEDED BY 102629-08
SUPERCEDED BY 108620

SUPERCEDED BY 102629-08

CROSS REFERENCE:

FOR ADDITIONAL LINES,
SEE DWGS. 102629, & 102630.

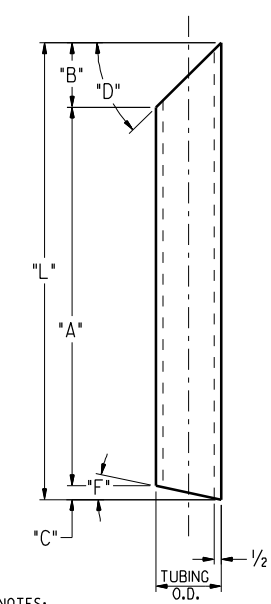

NOTES:

- ACTUAL TUBING O.D. FOR EACH LINE No. TO BE DETERMINED BY SHOP AND USED ACCORDINGLY.
- ROUND ALL DECIMAL DIMENSIONS ("A", "D", & "F") TO THE NEAREST HUNDREDTH.
- TO CALCULATE WEIGHT:
 $4\frac{1}{2}$ O.D. x $\frac{1}{2}$ " WALL = 21.36# PER FT.
 $4\frac{3}{16}$ O.D. x $\frac{1}{2}$ " WALL = 21.70# PER FT.
 $4\frac{5}{8}$ O.D. x $\frac{1}{2}$ " WALL = 22.03# PER FT.
- DIMENSIONS SHOWN ARE DESIGN DIMENSIONS. SHOP TO ADD $\frac{3}{16}$ " TO "A" & "L" LENGTHS AT FABRICATION.

MATERIAL:

$4\frac{1}{2}$ O.D. x $\frac{1}{2}$ WALL THK. x "L" I.G.
MECHANICAL TUBING, 1026 ASTM A-513 TYPE I. NORMALIZED IN PLACE OF ASTM A513 TOLERANCE, TOLERANCES OF ± 0.034 " FOR O.D. AND ± 0.050 " FOR WALL THICKNESS ARE ACCEPTABLE.

DRAWING NO.
102628

REVISION	A	B	C	D	E	F	G	H
DATE	20 MAR 1993	24 MAR 1993	24 AUG 1993	06 NOV 93	10 AUG 1994	15 SEP 1994	29 AUG 1997	14 DEC 1998
DRAWN	TW	TW	GG	B L	GG	GG	DRW	TW
ECO NO.								
CHECKED	RAB	RAB	RAB	RAB	TW	RZ	DF	TC
MFG. ENGINEER	N/A	N/A	N/A	N/A	N/A	N/A	N/A	N/A
PRODUCT ENGINEER	TER	TER	PCA	PCA	FR	PCA	DF	AH

FOR KALTENBACH
SAW ONLY

DEFAULT TOLERANCES	DETAIL DRAWING
ALL DIMENSIONS ARE INCHES UNLESS OTHERWISE NOTED	
FRACTIONAL DIMENSIONS: $\pm 1/16$	
ANGULAR DIMENSIONS: $\pm 1^\circ$	

U UNION TANK CAR CO.		H	
1617 S. BALDWIN AVE. EAST CHICAGO, INDIANA 46320		LATEST REVISION	
TUBING, CUT-TO-LENGTH FOR KALTENBACH SAW MITERED BOTH ENDS ASTM A513 TYPE I NORMALIZED			
DRAWN BY	DATE	SCALE	WEIGHT
TW	26 SEPT 91	N.T.S.	TABLED
N/A	N/A	PCA	PRODUCT
102628			ENGINEERING APPROVALS