

DEVELOPMENT

DRAWING NO.
100921

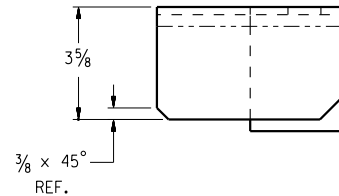
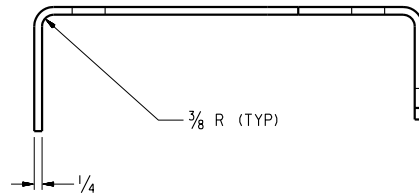
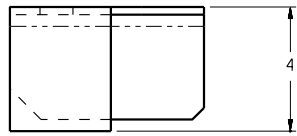

NOTE:
1.) BREAK ALL SHARP CORNERS.

MATERIAL:
1/4 x 6 1/8 x 19 3/16 LG.
STEEL, ASTM A283-GR. B

THIS DRAWING IS STANDARD
UPON REVISION OR LINE ADDITION
IT MUST BE DISTRIBUTED BY
BOM SUPERVISOR TO AREA'S 366
AND 393.

| | | |
|---------------|-----------------|-----------------|
| REVISION | D | F |
| DATE | 15 MAY 2001 | 11-15-01 |
| DRWN | TW | BKB |
| ECO NO. | LATEST REVISION | LATEST REVISION |
| CHECKED | TC | TW |
| MFG ENG'G | N/A | N/A |
| PRODUCT ENG'G | RS | TW/SFW |

WIDTH WAS 6 1/4 IN. 3/16 DIM WAS 3 1/4. 1/8 DIM. WAS 1 1/2.
REVISED DEVELOPMENT VIEW, 7 1/8 DIM WAS 8 7/8.

DEFAULT TOLERANCES - DETAIL DRAWING
ALL DIMENSIONS ARE IN INCHES UNLESS OTHERWISE NOTED
FUNCTIONAL DIMENSIONS: ± 3/16
ANGULAR DIMENSIONS: ± 1°

UNION TANK CAR Co.
51ST & RAILROAD AVE.
EAST CHICAGO, INDIANA 46312

THIS PRINT & ALL INFORMATION SET FORTH THEREON IS THE PROPERTY OF UNION TANK CAR COMPANY & IS LOANED IN CONFIDENCE SUBJECT TO RETURN UPON REQUEST & WITH THE UNDERSTANDING THAT NO COPIES SHALL BE MADE WITHOUT THE PRIOR WRITTEN CONSENT OF UNION TANK CAR COMPANY. ALL RIGHTS TO DESIGN & INVENTION ARE RESERVED.

| | | | | |
|--------------------------------|----------|---------|--------|-------------|
| RESERVOIR SUPPORT TWO HOLES | | | | |
| DRWN BY | DATE | SCALE | WEIGHT | CHECKED |
| WTC | 10/17/89 | 4 = 12 | 6.00# | AEH |
| N/A | N/A | PCA | | |
| WELDRG | MFG | PRODUCT | | |
| ENGINEERING APPROVALS | | | | DRAWING NO. |
| | | | | 100921 |

100921